

## Accommodation Details – NCR Port Island

### <Address>

6-3-4 Minatojima-Nakamachi, Chuo-ku, Kobe, Hyogo 650-0046, Japan

(No home phone installed in the room)

### <Location & transportation>

8 minutes on foot from Minatojima Station of the Port-Liner; 15 minutes on foot to Kobe Gakuin University.

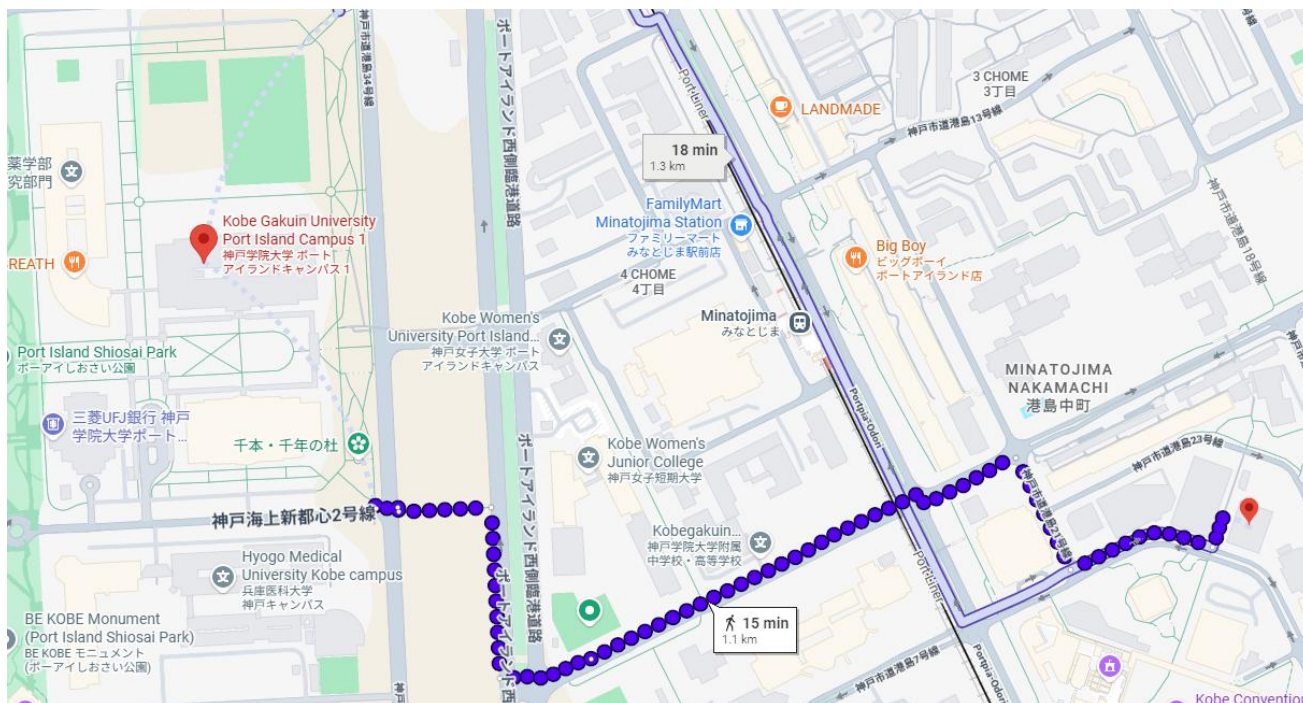

### <Facilities>

Your accommodation is a single-occupancy 1K-style room with a small kitchen and a living area.

Facilities include a single bed, desk with a wagon and one chair, washing machine, refrigerator, microwave, shoe rack, air conditioner, and Wi-Fi.

For other facilities, please refer to the floor plan and the list below.

Students are also required to prepare other necessary daily items on their own.

※Bedding set is not provided in the accommodation. Please prepare your own bedding before or after arrival.

### <Meals>

Breakfast and dinner are provided. The monthly fee is 28,600 yen (tax included).

※Meals are not provided on weekends, national holidays, during the summer vacation, or over the New Year holidays.

### <Dormitory Fees>

The monthly rent is 38,000 yen. Utilities (electricity, gas, water) are excluded.

### <Date of Move-in & Move-out>

#### Spring Semester (April–August)

Move-in: 10:00-14:30 26th–31st March (Weekdays)

Move-out: Before 7th August

#### Fall Semester (September–February)

Move-in: 10:00-14:30 5th–8th September (Weekdays)

Move-out: Before 12th February 2027

The dormitory arrangements will be finalized and announced around late December. We apologize for any inconvenience this may cause and appreciate your understanding. In the meantime, please refer to the above information as a general guide.

Floor plan (Room type cannot be specified.)

List of equipment

AType

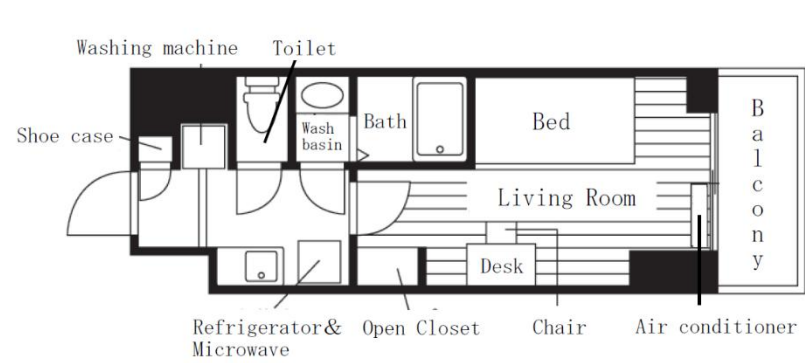

BType

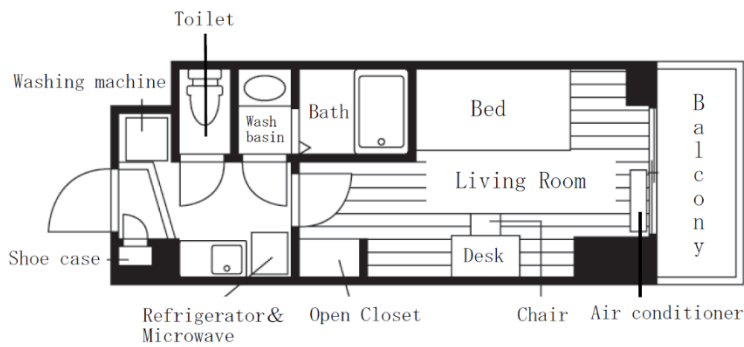

- Washing machine
- Refrigerator
- Microwave
- Single bed
- Shoe Box
- desk with a wagon
- 1 chairs
- Air conditioning
- Free Wi-Fi
- tabletop induction cooktop

Room Photos (Image)

